

UMP6PzB600

2V 600AH

Motive Power

Ultracell®

'Quality in Every Language'

UMP6PzB600

Awaiting Image

Physical Specification

Part Number	UMP6PzB600
Length	109 ± 2 mm
Width	158 ± 2 mm
Container Height	690 ± 2 mm
Total Height (with terminal)	722 ± 2 mm
Without Electrolyte	34.7 kg
With Electrolyte	26.2 kg

Specifications

	Nominal Voltage	2V
	Nominal Capacity	600AH
Terminal Type	Standard Terminal	M10
Container Material	Standard Option	PP
Rated Capacity	5hr, 1.75V/cell, 25°C	600.0 AH/120.0A
Max Discharge Current	4800 A (5s)	
Discharge Characteristics	Operating Temp. Range	Discharge: -15°C ~ 55°C
		Charge: 0°C ~ 50°C
		Storage: 5°C ~ 40°C
Cycle Use	Capacity affect by Temperature	Initial Charging Current : less than 84.0A.
		Voltage : 2.40V ~ 2.50V
		Temp. Coefficient : -5mV/°C
	40°C	103%
	25°C	100%
	0°C	86%
Design Floating Life at 20°C	15 Years	
Self Discharge	Ultracell batteries may be stored for up to 6 months at 25°C(77°F) and then a refresh charge is required. For higher temperatures the time interval will be shorter.	

Dimensions

M10 Terminal

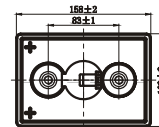
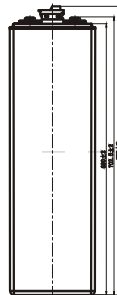
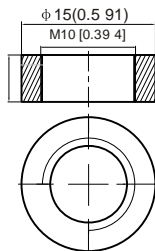

Discharge Characteristics

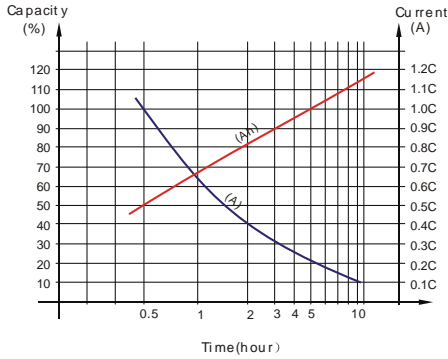

Electrolyte Density in Relation to Voltage

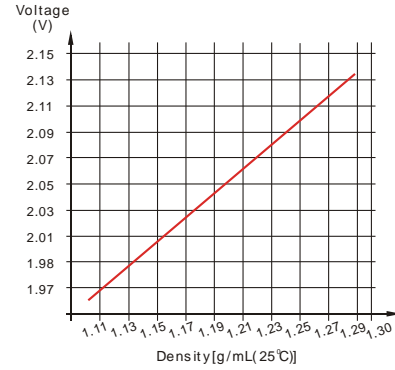

Electrolyte Density in Relation to Capacity

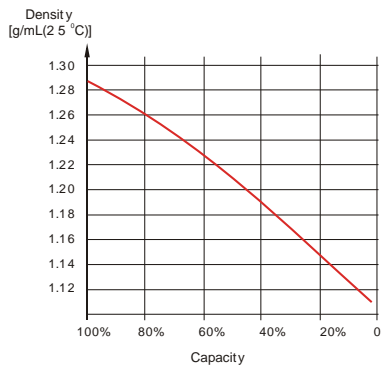

Temperature in Relation to Battery Capacity

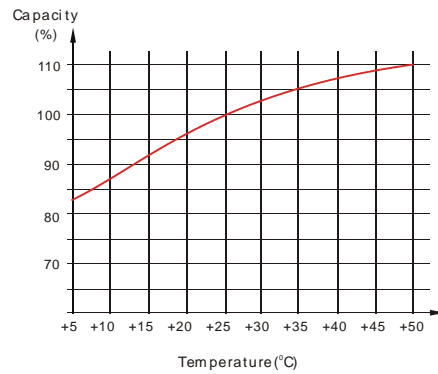

Discharge Characteristics

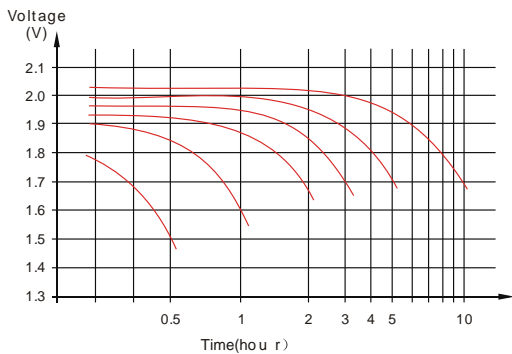

Cycle Life in Relation to Depth of Discharge

